



12 REYNOLDS PARK, 8 BELL CLOSE, PLYMOUTH PL7 4FE

TO LET £12,000pa.intl.excl

Listers
~ PROPERTY CONSULTANTS

LOCATION:

Situated within the Newnham industrial estate which forms the northern part of Plympton. Bell Close is principally industrial with trade counter and warehouse units. Nearby occupiers include Morris engineering, Co-Operative distribution, Gardner European and Aldermans.

DESCRIPTION:

Modern mid-terraced two-storey industrial/warehouse/trade-counter unit built in 2013, of block construction with profile steel elevations under a mono-pitch roof with double-glazed windows and a roller-shutter door 2.95m wide x 5.1m high. Min. eaves height of 5.26m. The accommodation has been partitioned to offer warehouse/store, 3 offices, kitchenette and 2 WCs. Externally there is parking for one car plus delivery apron.

Note: Restrictive covenant NO MOTOR TRADE PERMITTED.

SCHEDULE OF ACCOMMODATION:

Area	Sq Ft	Sq M
Ground Floor	1,002	93
Total	1,002	93

LEASE TERMS:

Available FROM JULY 2024, offered to let on new flexible leasehold terms at an initial annual rent of £12,000pa + VAT.

VAT:

All the above prices/rentals are quoted exclusive of VAT.

LEGAL COSTS:

Each party to bear their own costs in regards to this transaction.

BUSINESS RATES:

We refer you to the government website <https://www.tax.service.gov.uk/view-my-valuation/search> which shows that the current rateable value is £15,000. To find out how much business rates will be payable there is a business rates estimator service via the website.

ENERGY PERFORMANCE CERTIFICATE:

The Energy Performance Rating for this property is C (64).

VIEWING AND CONTACT INFORMATION:

Strictly through Listers. Please contact either:-

Gareth Forrest on 01752 222135

Ifan Rhys-Jones on 01752 222135

enquiries@listers.uk.com



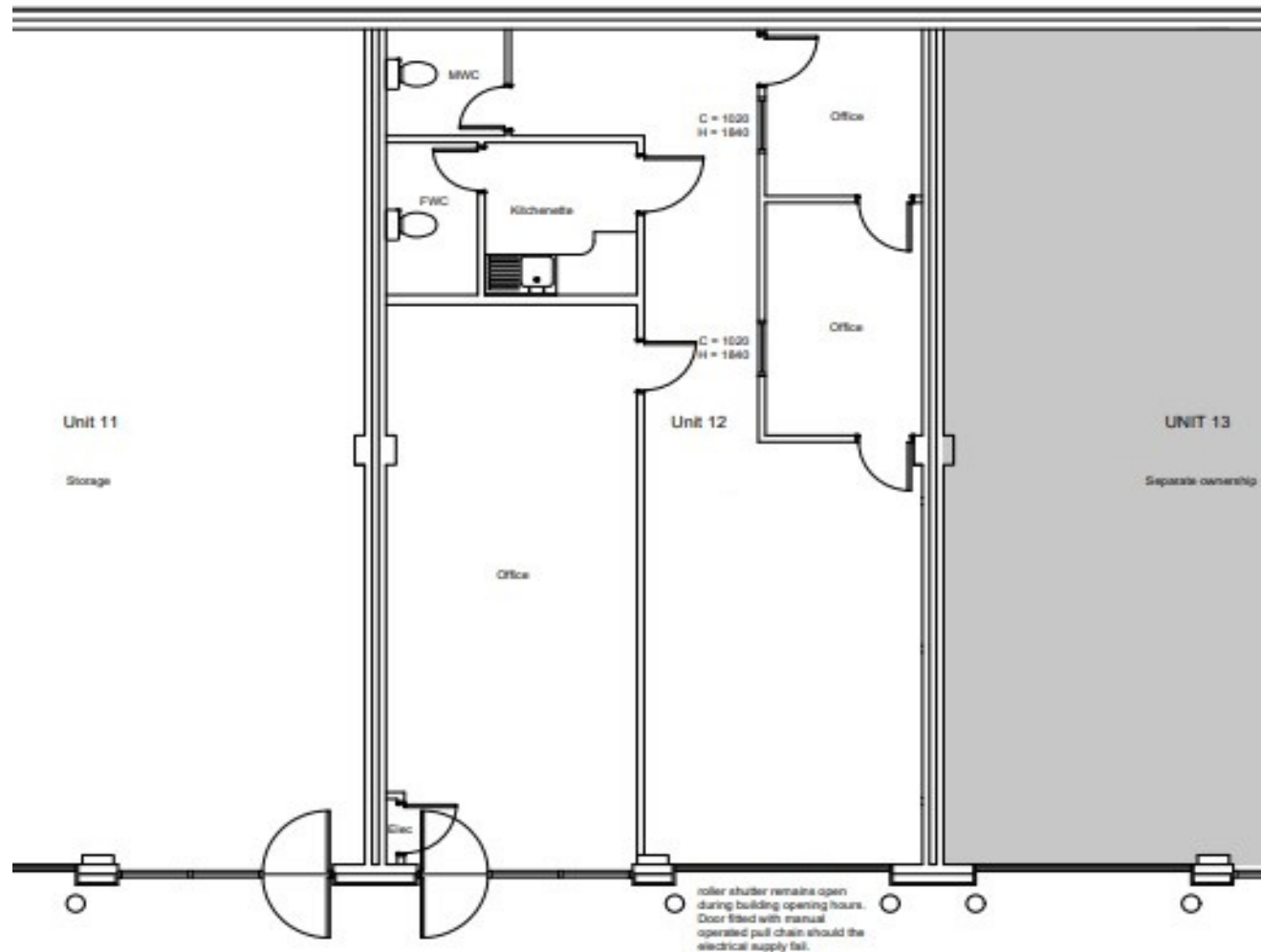

AGENTS NOTE: Listers Property Consultants Ltd for themselves and for the Vendor/s or lessor/s of this property give notice: [a] These particulars are for an intending purchaser or tenant and although they are believed to be correct their accuracy is not guaranteed and any error or misdescriptions shall not annul the sale or be grounds on which compensation may be claimed and neither do they constitute any part of a Contract: [b] No responsibility is taken for expenses incurred should the property be sold, let or withdrawn before inspection: [c] None of the services or appliances, plumbing, heating or electrical installations have been tested by the selling agent. Listers Property Consultants Ltd is registered in England and Wales under Registration No.08473324. The Registered Office is Mansion House, Princes Street, Truro TR1 2RF. VAT Registration No.159 0357 01